

# Planning Committee

**Wednesday 23<sup>rd</sup> September 2020**



[www.redditchbc.gov.uk](http://www.redditchbc.gov.uk)

**20/00850/PIP**

Land Adjacent To Feckenham Gardens,  
Astwood Lane, Feckenham, Redditch,  
Worcestershire, B96 6JQ

Permission in principle for the erection of  
5 - 9 Dwellings

Recommendation: Refuse



[www.redditchbc.gov.uk](http://www.redditchbc.gov.uk)

# Site Plan

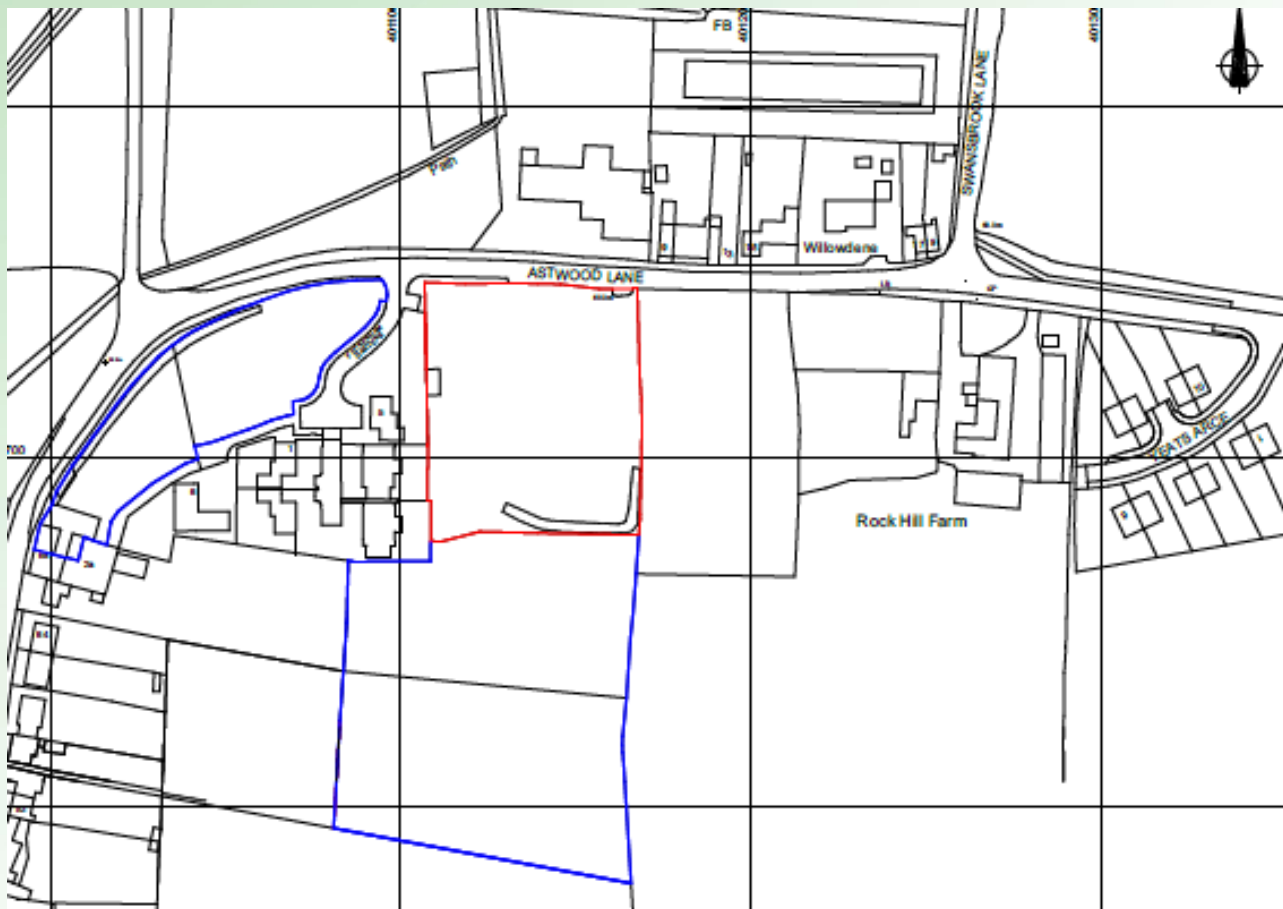

# Site Survey

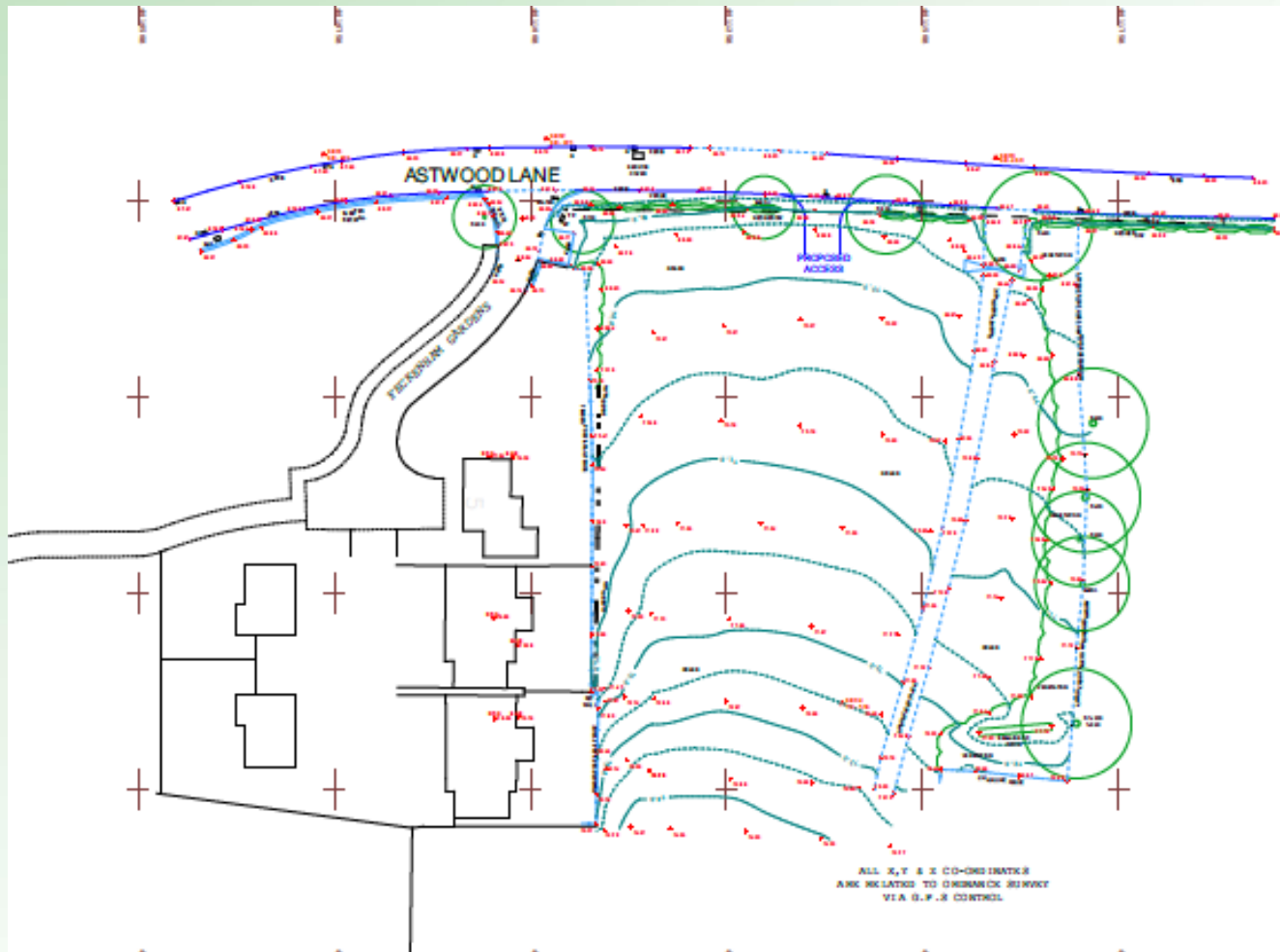

REDDITCH BOROUGH COUNCIL

*making  
difference*

[www.redditchbc.gov.uk](http://www.redditchbc.gov.uk)

# Planning Constraints



# Aerial View





# Site Photos



Access to site



REDDITCH BOROUGH COUNCIL

making  
difference

[www.redditchbc.gov.uk](http://www.redditchbc.gov.uk)

# Site Photos



West view into Feckenham



View towards the east (cottages to north)



# Site Photos



Rockhill Farm



Feckenham Gardens